

The Sustainable Development Strategy

2. Promoting Sustainable Development



Green Belt boundary amendments to the existing Green Belt and Rural Area boundary:

Hemel Hempstead		
GB/1	LA1 Marchmont Farm, Hemel Hempstead	Local Allocation – removal from the Green Belt and addition to the settlement of Hemel Hempstead
GB/2	LA2 Old Town, Hemel Hempstead	Local Allocation – removal from the Green Belt and addition to the settlement of Hemel Hempstead
GB/3	LA3 West Hemel Hempstead	Local Allocation – removal from the Green Belt and addition to the settlement of Hemel Hempstead
GB/4	Land at A41 between Old Fishery Lane and London Road, Hemel Hempstead	Removal from the Green Belt and addition to the settlement of Hemel Hempstead
GB/5	Land at A41 land adjoining Roughdown Common and Hemel Hempstead station	Regularising of Green Belt boundary including: a small addition to the Green Belt; and larger area removed from the Green Belt and addition to the settlement of Hemel Hempstead
GB/6	Land at the junction of Lower Road and Bunkers Lane. Hemel Hempstead	Removal from the settlement of Hemel Hempstead and addition to the Green Belt
Berkhamsted		
GB/7	LA4 Hanburys, Berkhamsted	Local Allocation – removal from the Green Belt and addition to the settlement of Berkhamsted
GB/8	Land above the Chiltern Park Estate, Berkhamsted	Removal from the settlement of Berkhamsted and addition to the Green Belt
Tring		
GB/9	LA5 West Tring	Local Allocation – removal from the Green Belt and addition to the settlement of Tring
GB/10	Land at and adjoining Garden House, London Road, Tring	Removal from the Green Belt and addition to the settlement of Tring
GB/11	Land at Ridge View off Marshcroft Lane, Tring	Removal from the settlement of Tring and addition to the Green Belt
Bovingdon		
GB/12	LA6 Bovingdon	Local Allocation – removal from the Green Belt and addition to the settlement of Bovingdon
GB/13	Land at Bovingdon Court, Bovingdon	Removal from the settlement of Bovingdon and addition to the Green Belt
GB/14	Land at Chipperfield Road, Bovingdon	Removal from the Green Belt and addition to the settlement of Bovingdon
GB/15	Land at Church Street, Bovingdon	Removal from the settlement of Bovingdon and addition to the Green Belt





Markyate		
GB/16	127a London Road, Markyate	Removal from the Green Belt and addition to the settlement of Markyate
GB/17	Land rear of Farrier Top and High View, Markyate	Removal from the Green Belt and addition to the settlement of Markyate.
Other		
GB/18	Land west of Cupid Green Lane north of Hemel Hempstead	Removal from the Rural Area and addition to the Green Belt
GB/19	Land at Frithsden Beeches, Berkhamsted Common	Regularising of the Green Belt to align boundary to field boundary including small scale addition and removal from the Green Belt to the Rural Area
GB/20	Land adjoining New Road, Berkhamsted Common	Removal from the Green Belt and addition to the Rural Area

Key to Proposed Green Belt Boundary Amendments:

EXISTING BOUNDARY:

-  INNER GREEN BELT BOUNDARY WITH A SETTLEMENT
-  OUTER GREEN BELT BOUNDARY WITH THE RURAL AREA
-  OUTER GREEN BELT BOUNDARY WITH MARKYATE

PROPOSED BOUNDARY:

-  INNER GREEN BELT BOUNDARY
-  OUTER GREEN BELT BOUNDARY WITH THE RURAL AREA
-  OUTER GREEN BELT BOUNDARY WITH MARKYATE
-  LAND TO BE REMOVED FROM THE GREEN BELT
-  LAND TO BE ADDED TO THE GREEN BELT

GB/1 LA1 Marchmont Farm, Hemel Hempstead:

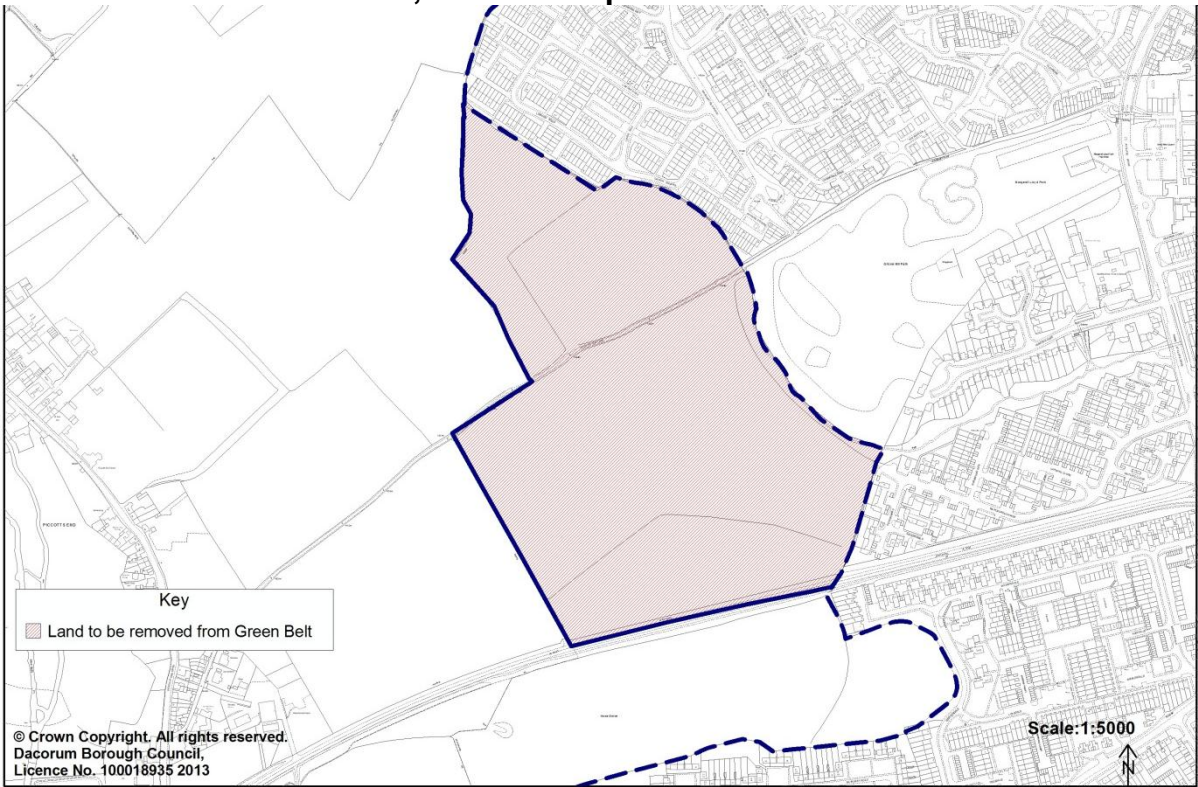

GB/2 LA2 Old Town, Hemel Hempstead:

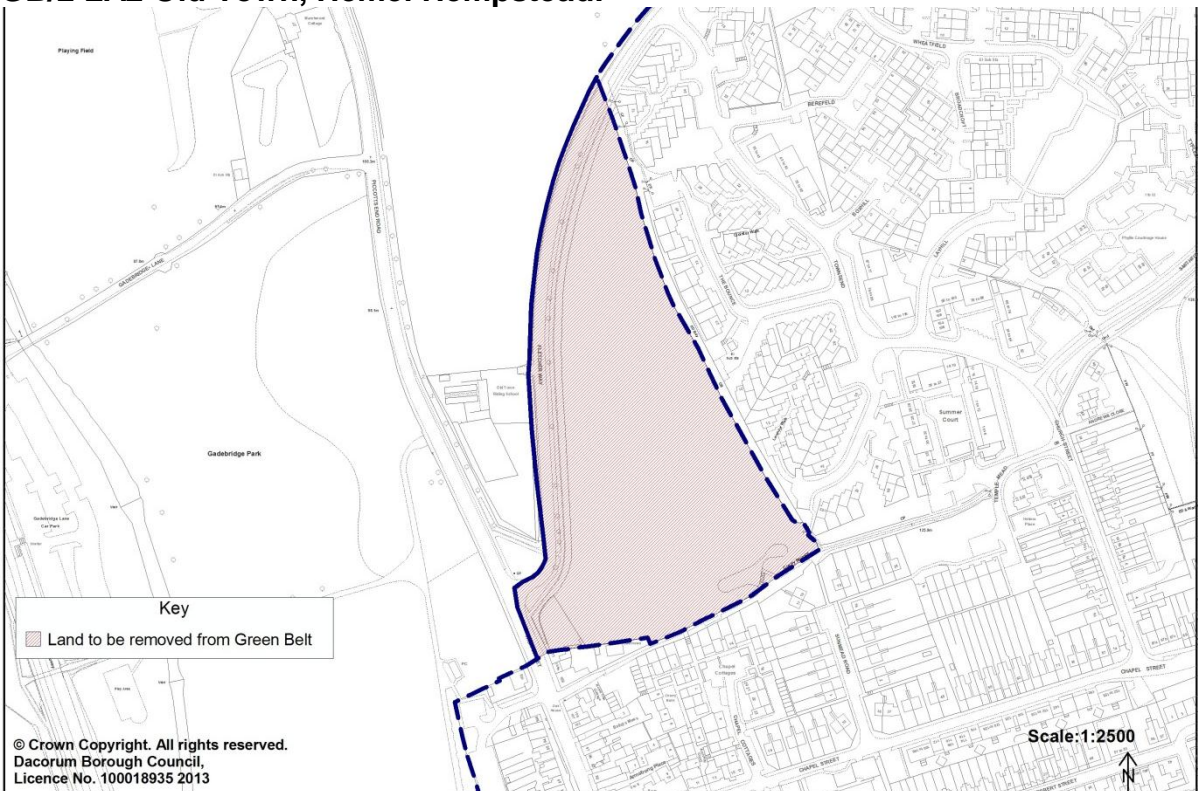

GB/3 LA3 West Hemel Hempstead:

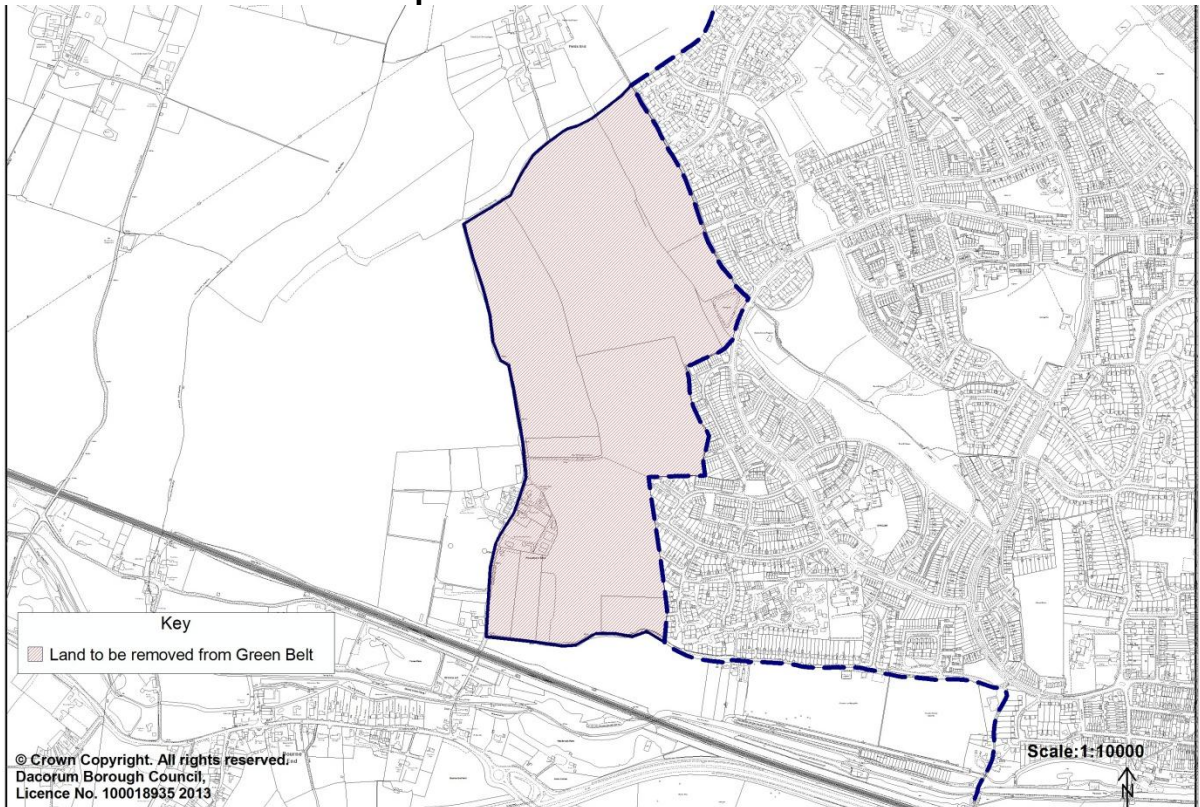

GB/4 Land at A41 between Old Fishery Lane and London Road, Hemel Hempstead:

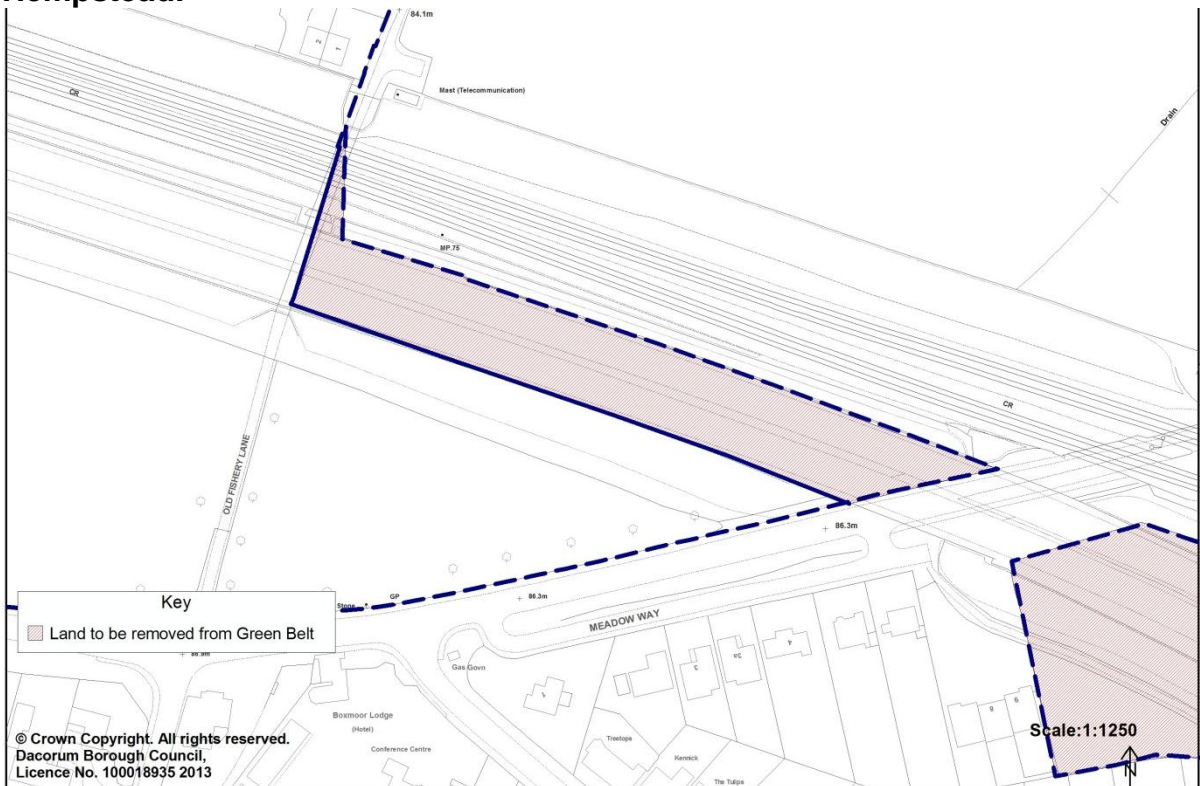

GB/5 Land at A41 land adjoining Roughdown Common and Hemel Hempstead station:



GB/6 Land at the junction of Lower Road and Bunkers Lane, Hemel Hempstead

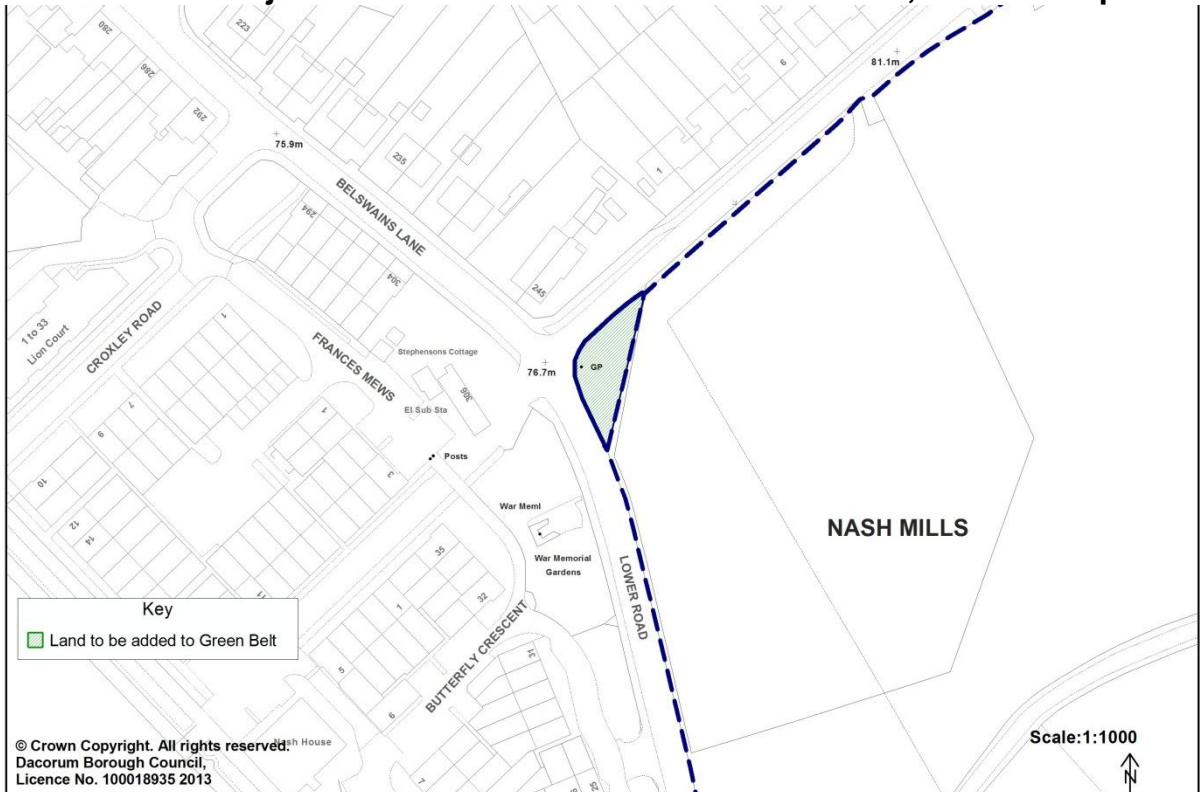

GB/7 LA4 Hanburys, Berkhamsted

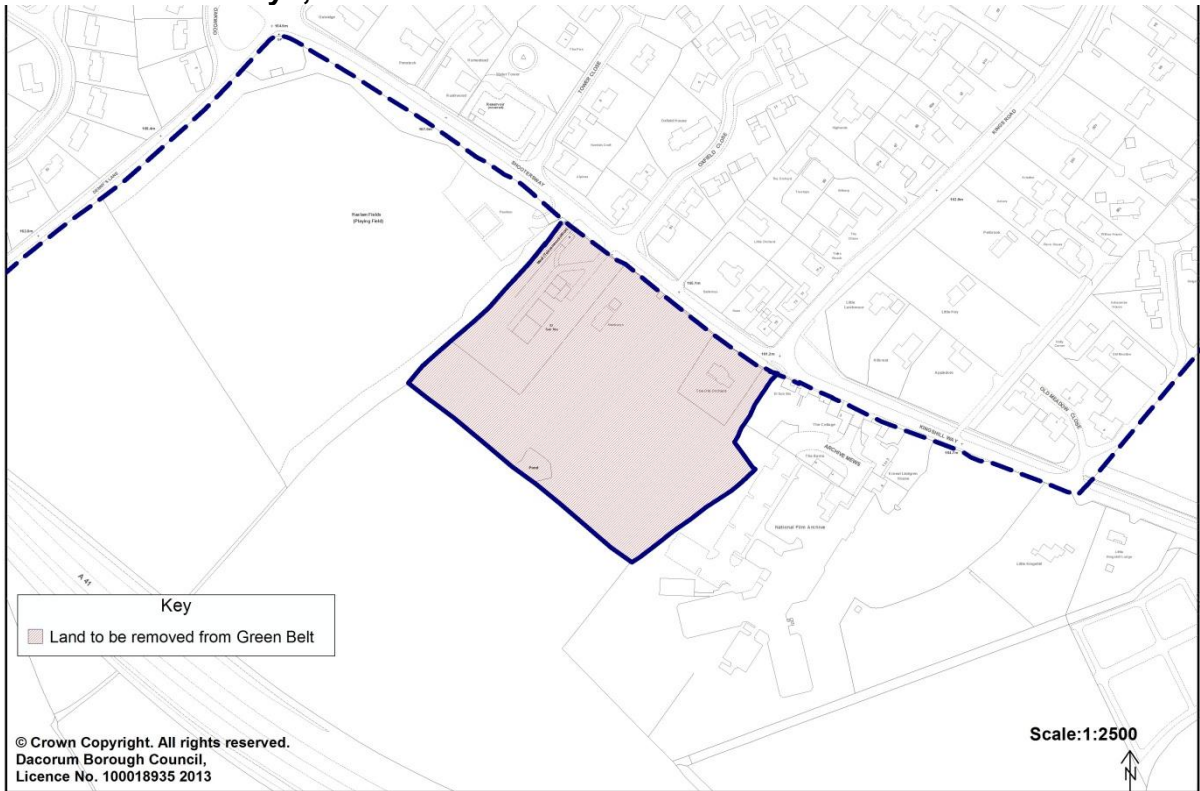

GB/8 Land above the Chiltern Park Estate, Berkhamsted:



GB/9 LA5 West Tring:

SC1 (below)

Map in previous Pre-submission document:

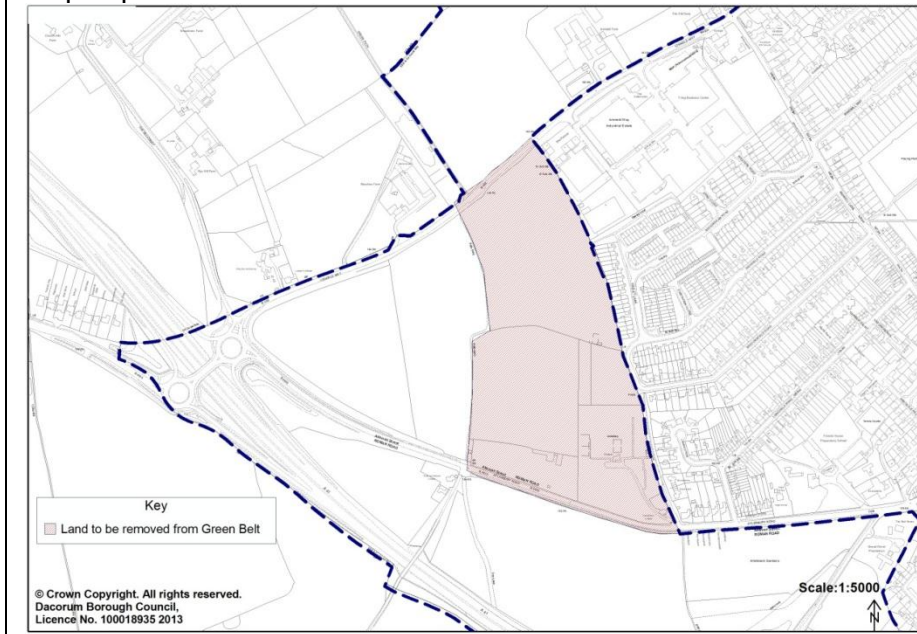

Amended map:

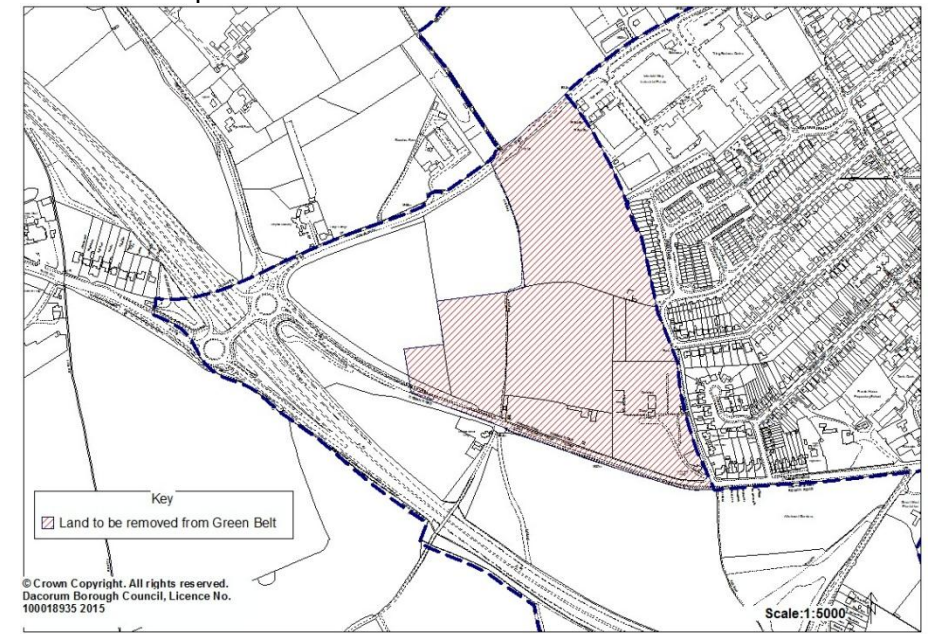

GB/10 Land at and adjoining Garden House, London Road, Tring:

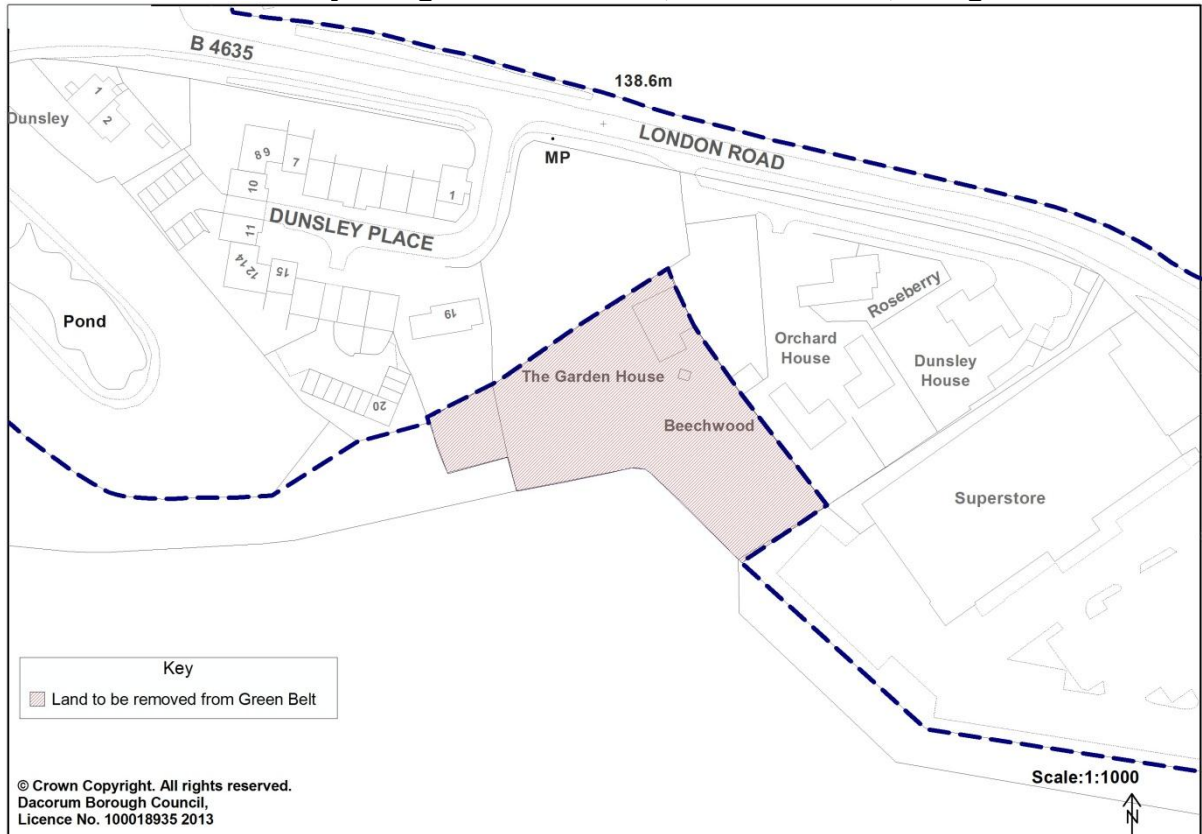

GB/11 Land at Ridge View off Marshcroft Lane, Tring:

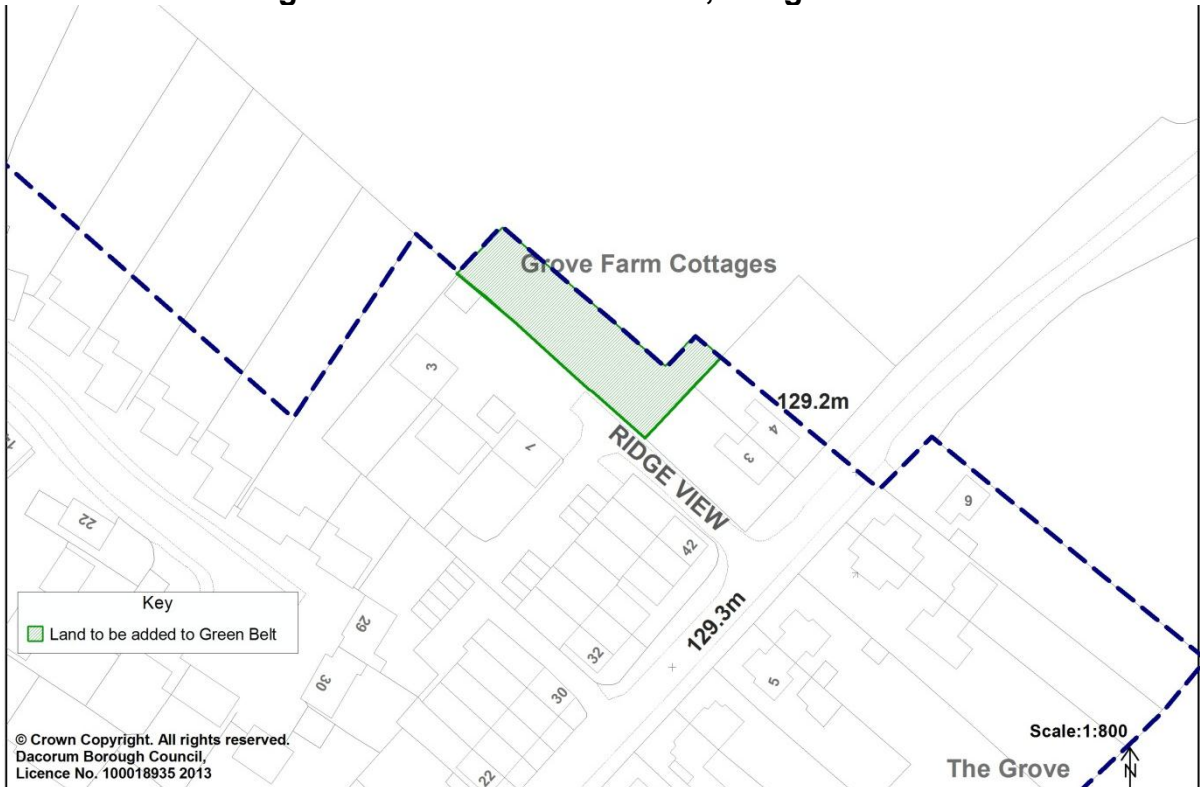

GB/12 LA6 Bovingdon:

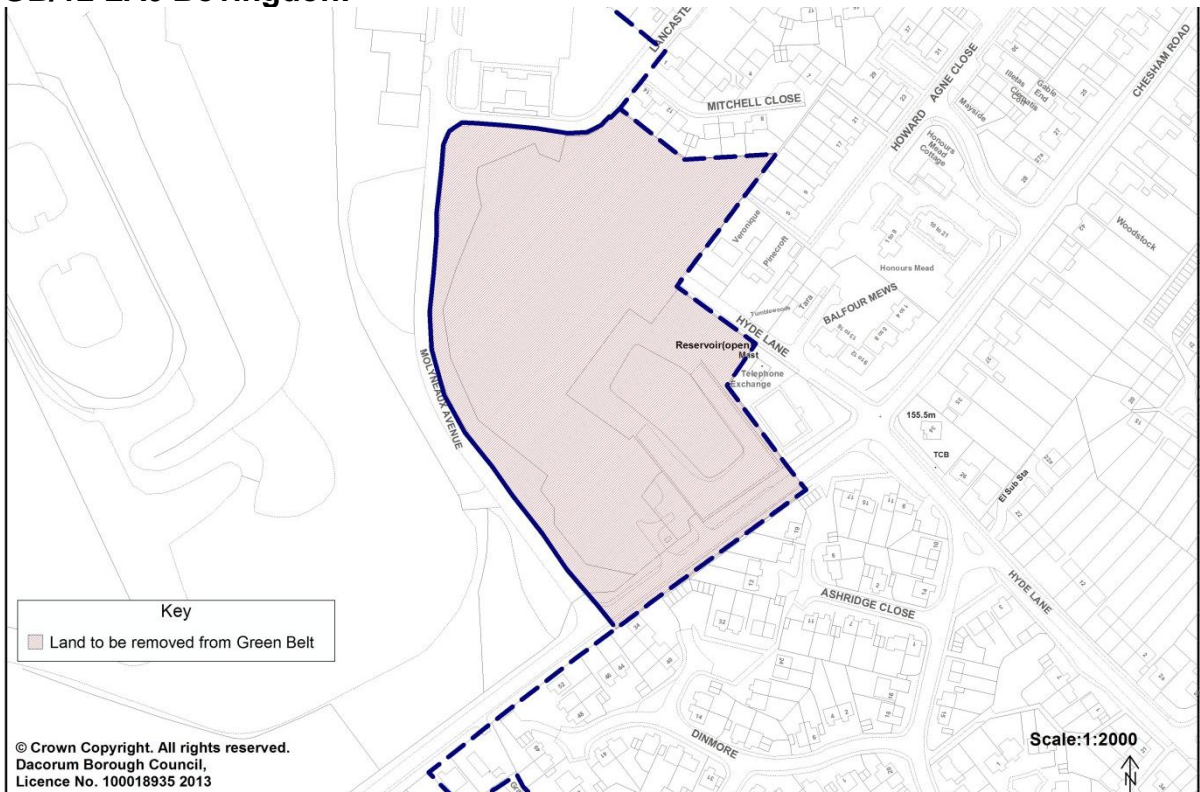

GB/13 Land at Bovington Court, Bovington:



GB/14 Land at Chipperfield Road, Bovington:

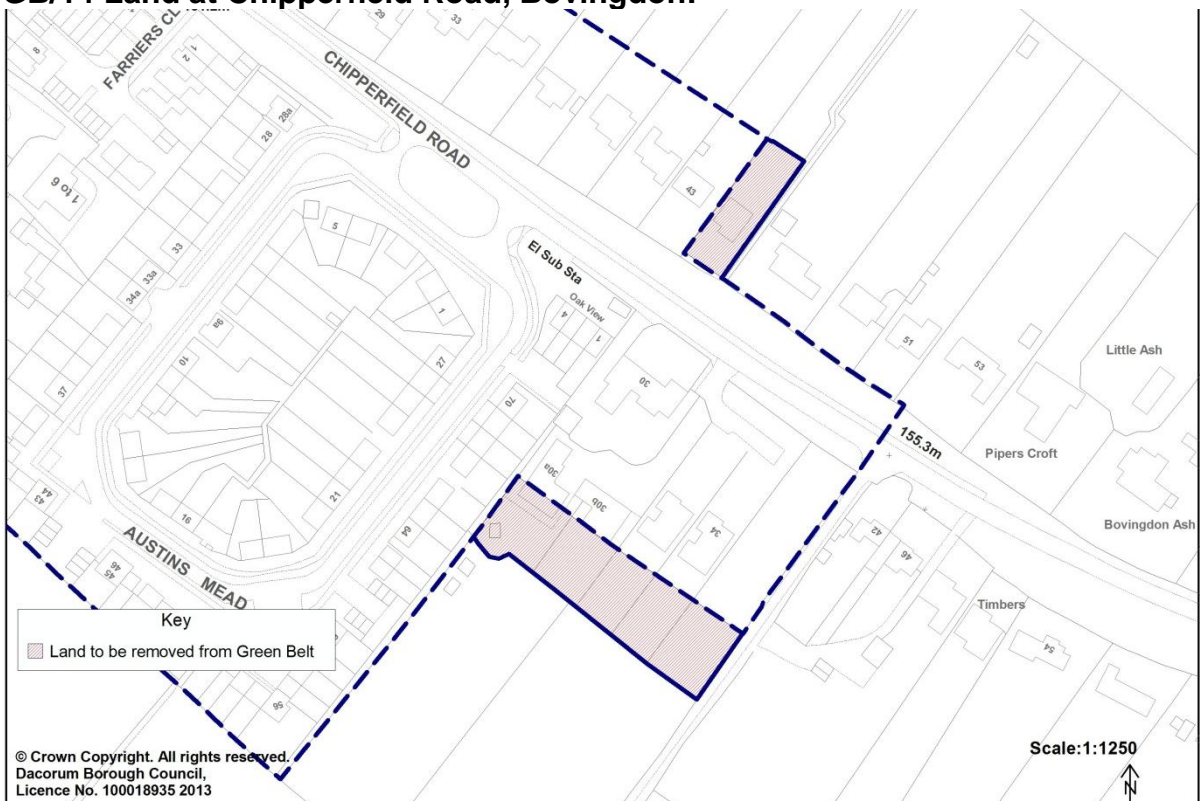

GB/15 Land at Church Street, Bovington:



GB/16 127a London Road, Markyate:

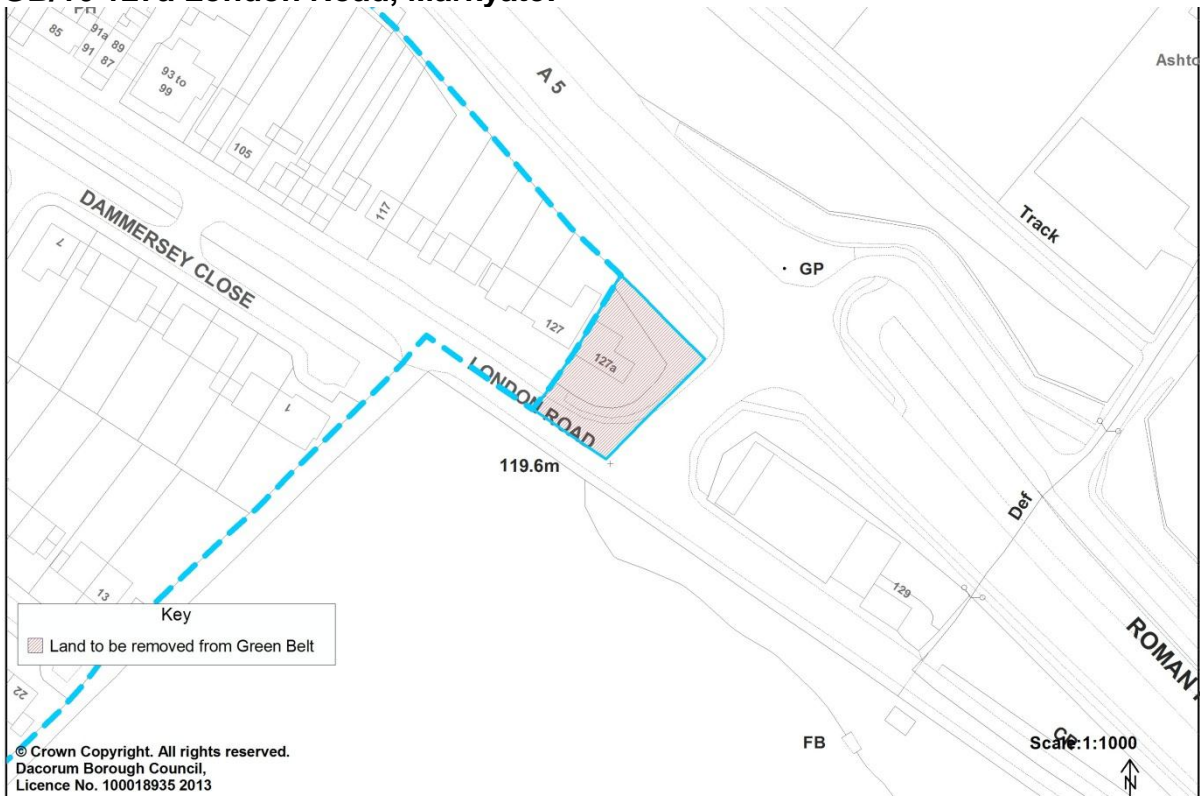

GB/17 Land rear of Farrer Top and High View, Markyate:

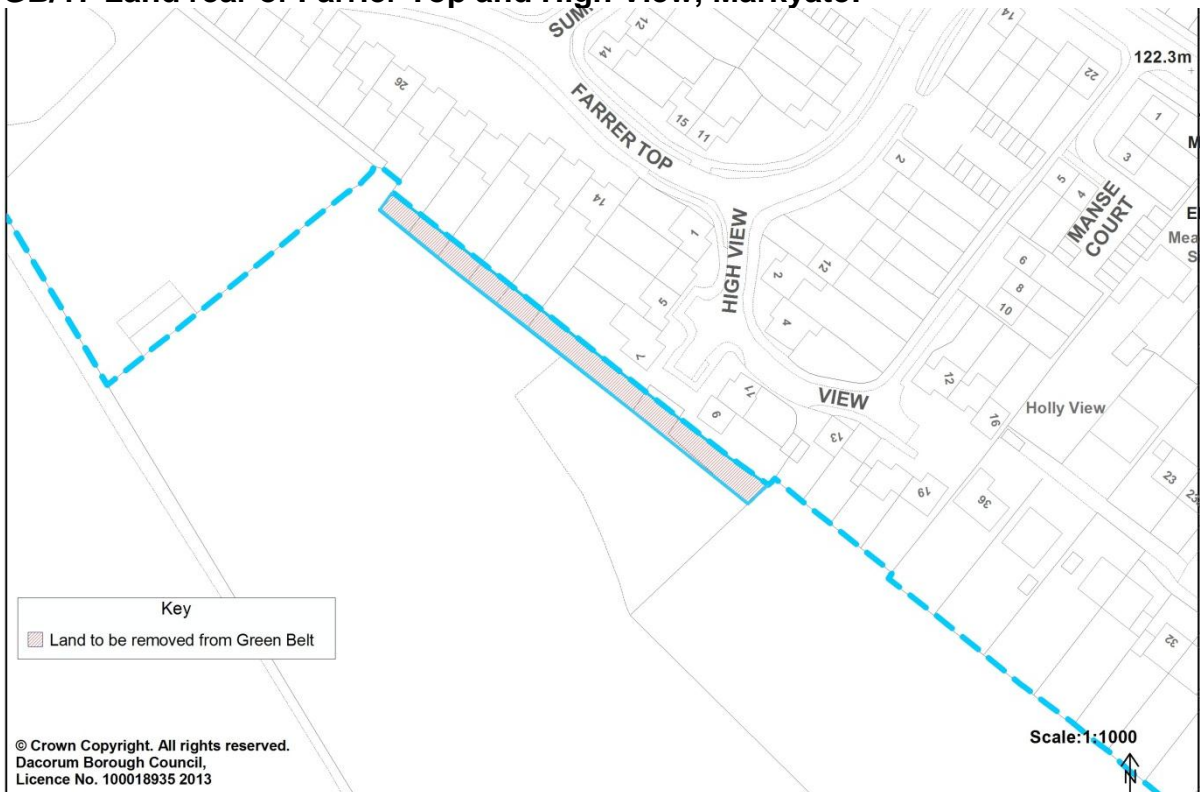

GB/18 Land west of Cupid Green Lane north of Hemel Hempstead:

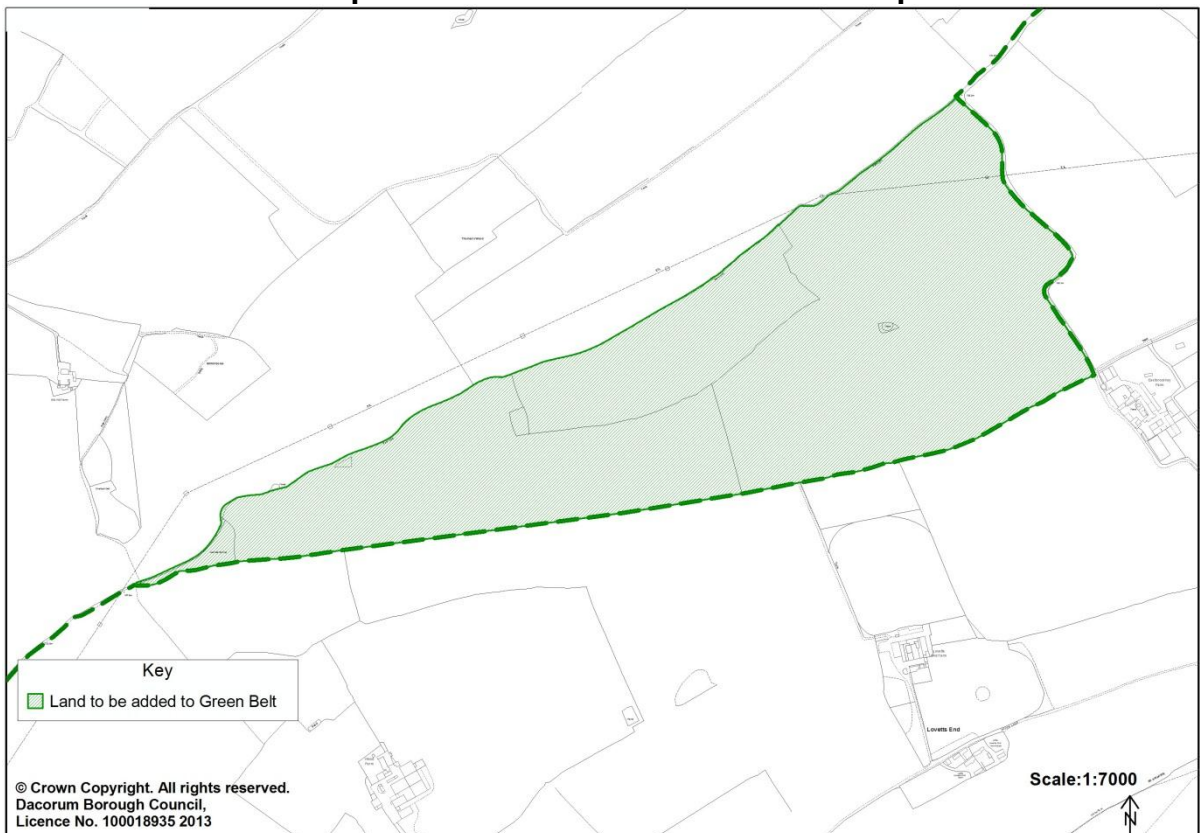

GB/19 Land at Frithsden Beeches, Berkhamsted Common:

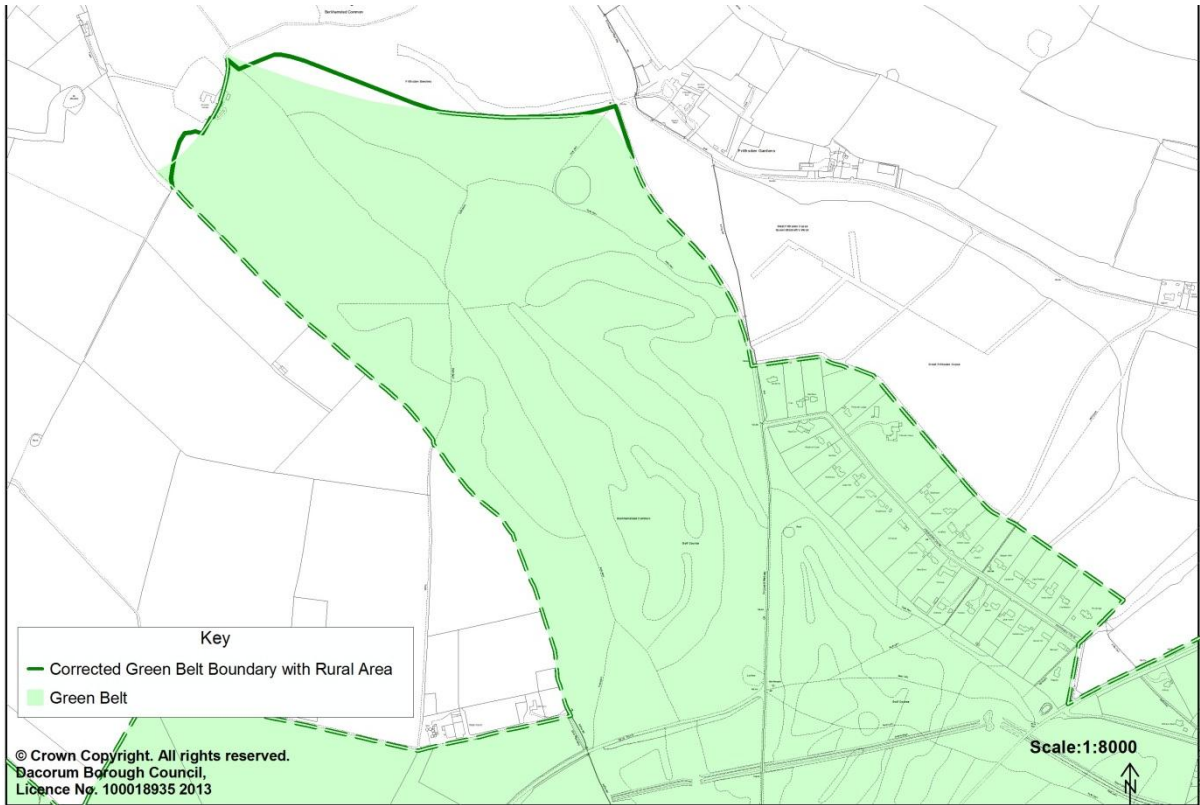

GB/20 Land adjoining New Road, Berkhamsted Common:



Small Villages in the Green Belt

The amendments to the village boundaries below relate to additions to the following villages, where new sites are now to be included within the village envelope

VB/1 Garden Scene Nursery, Hermes and The New Bungalow

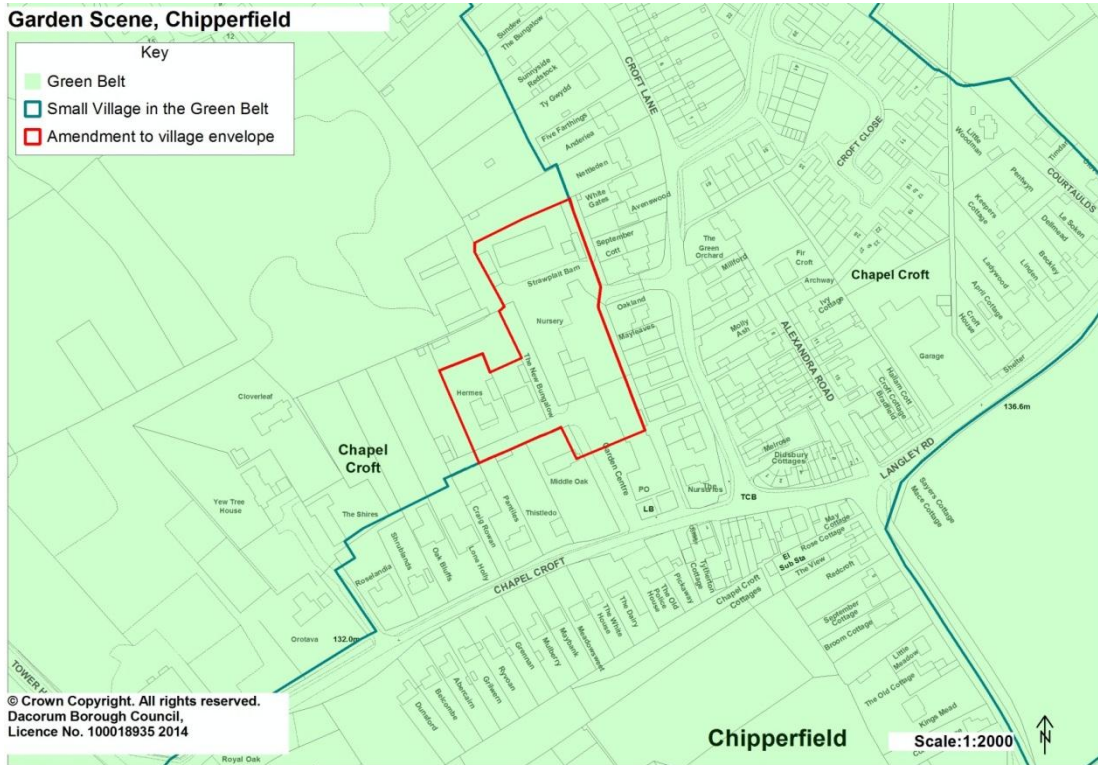

VB/2 22 and 23 College Close

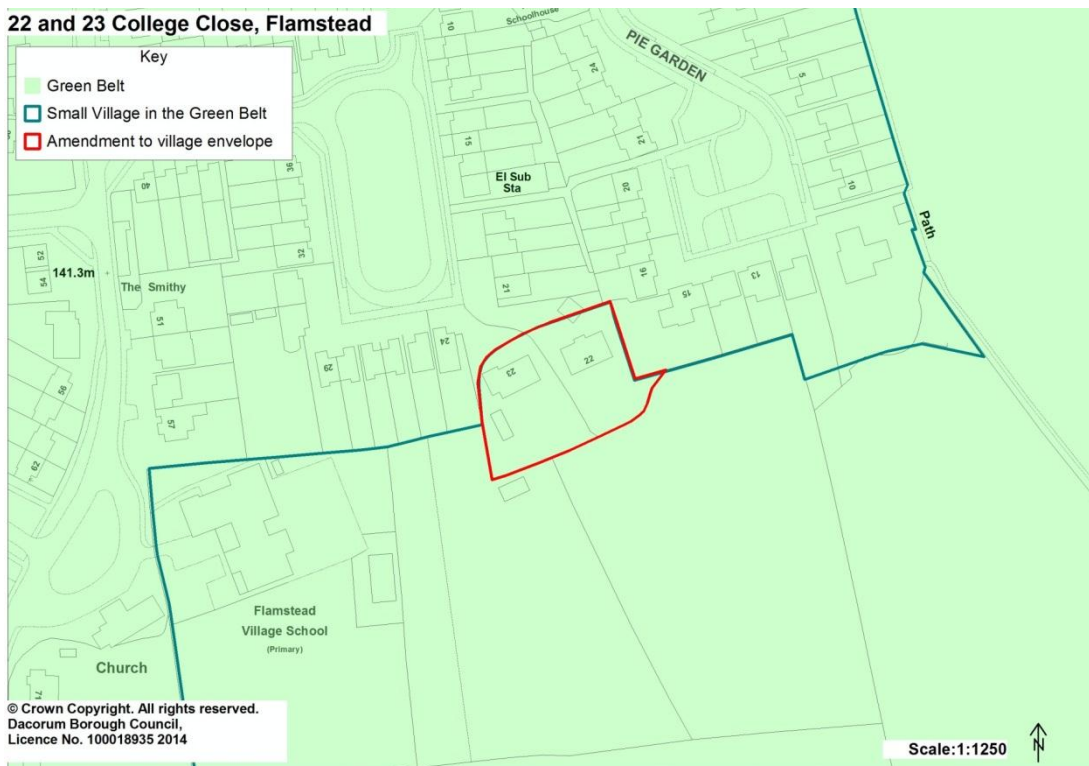

VB/3 Linnins Pond, Flamstead



Small Villages in the Rural Area

The amendments to the village boundaries below relate to an addition and a correction to Long Marston

VB/4 Rear garden at 25 Cheddington Road

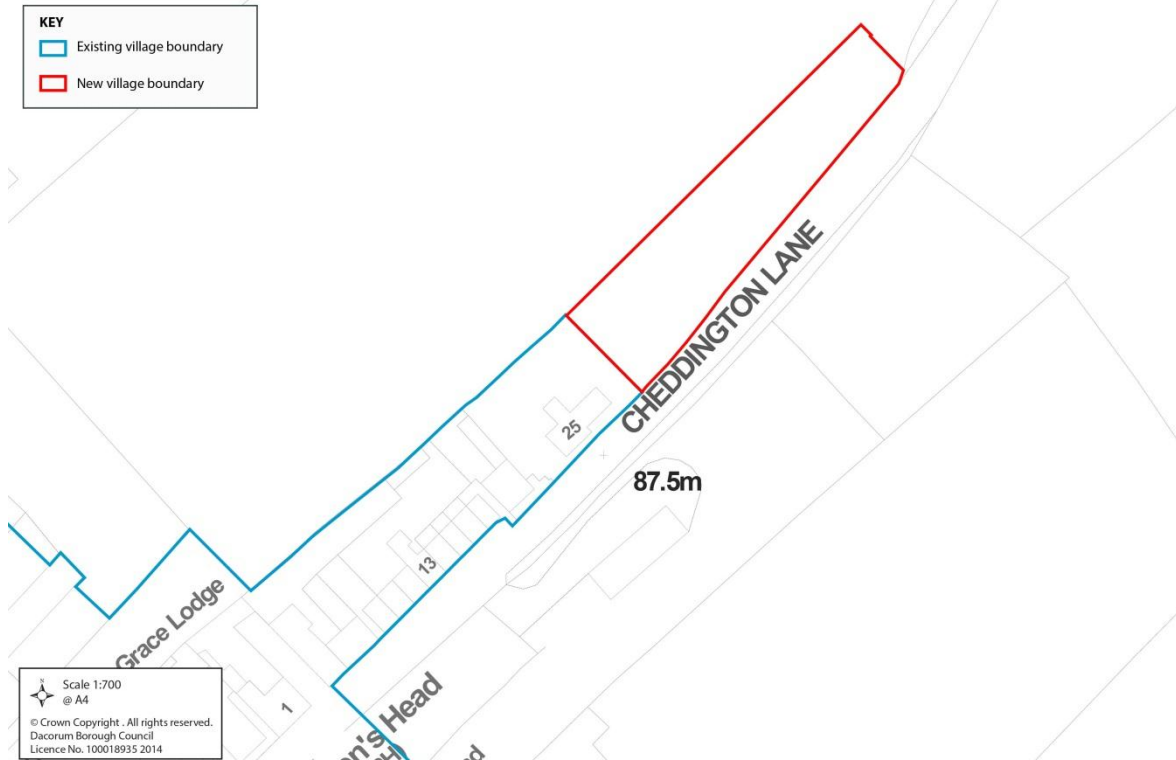

VB/5 Land r/o 16 to Pembroke Cottage, Tring Road, Long Marston

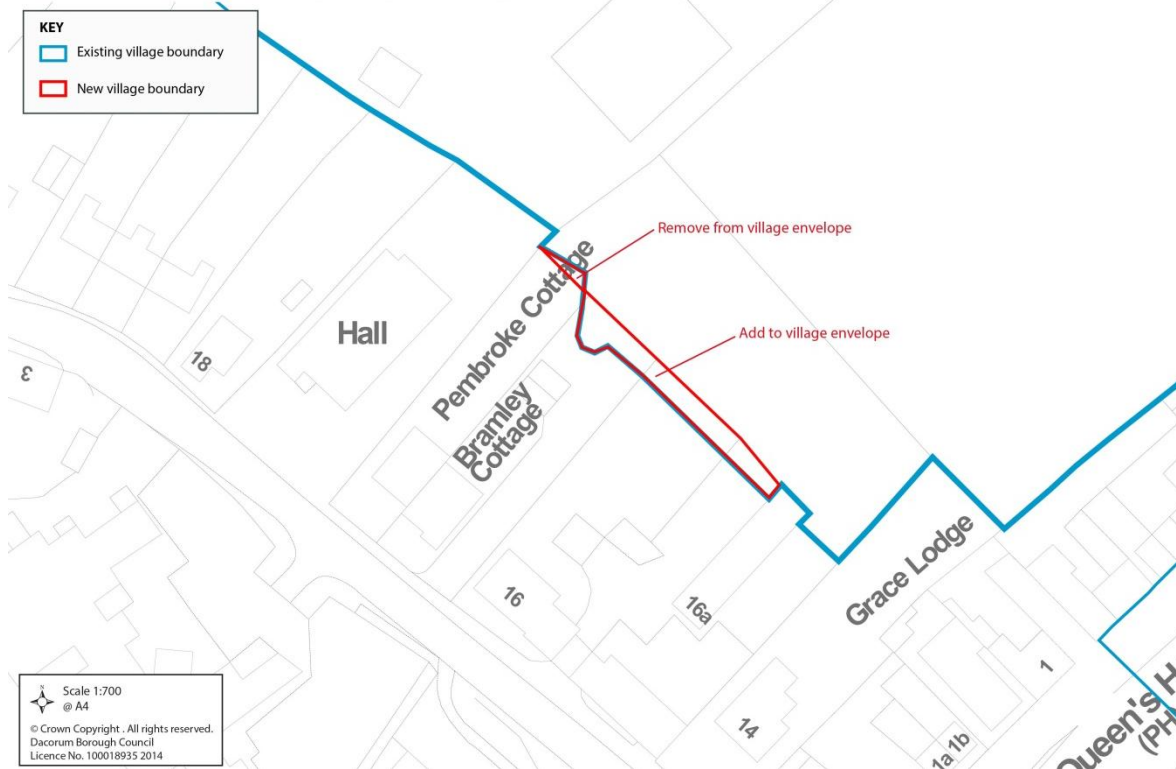

Major Developed Sites in the Green Belt

SC2 (below)

MDS/1 Abbots Hill School - Defined boundaries for New Major Developed Site in the Green Belt

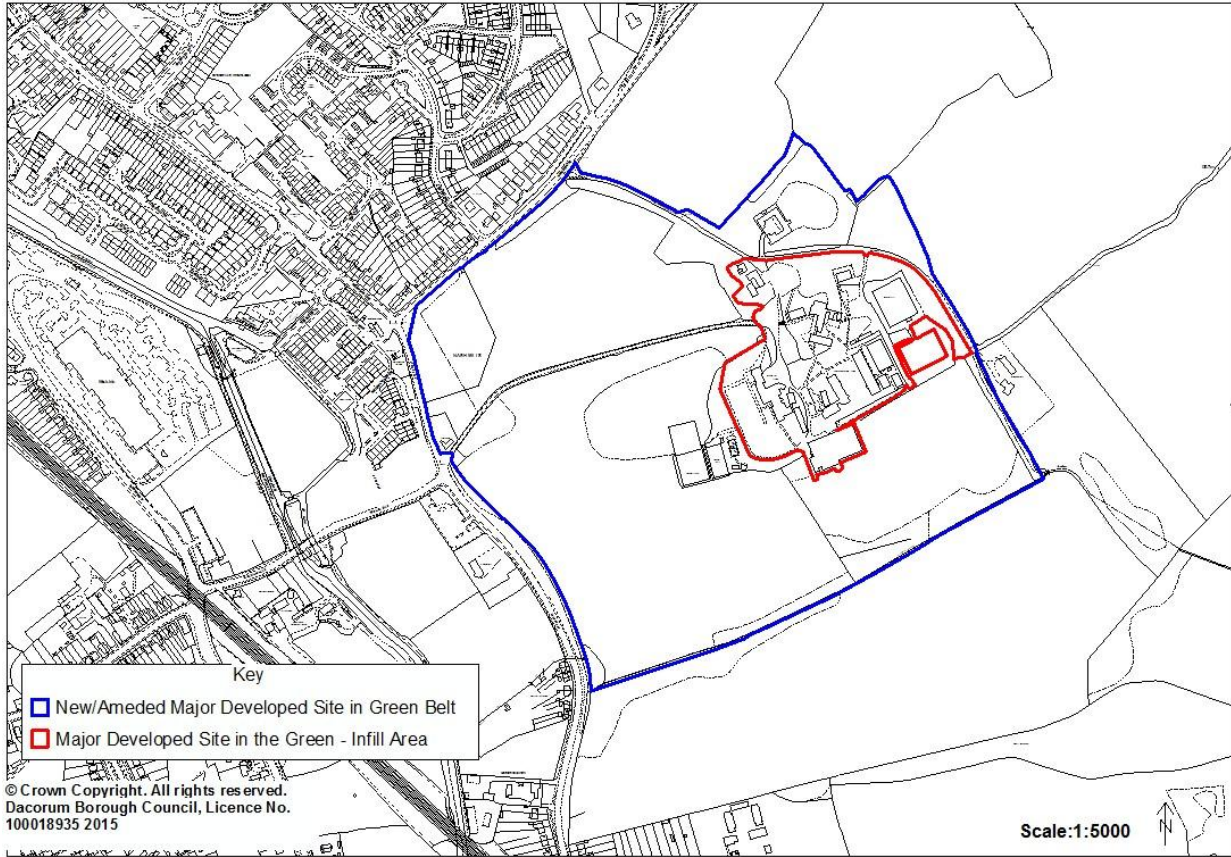

MDS/4 MDS/2 Berkhamsted Castle Village – Extended Infill Area

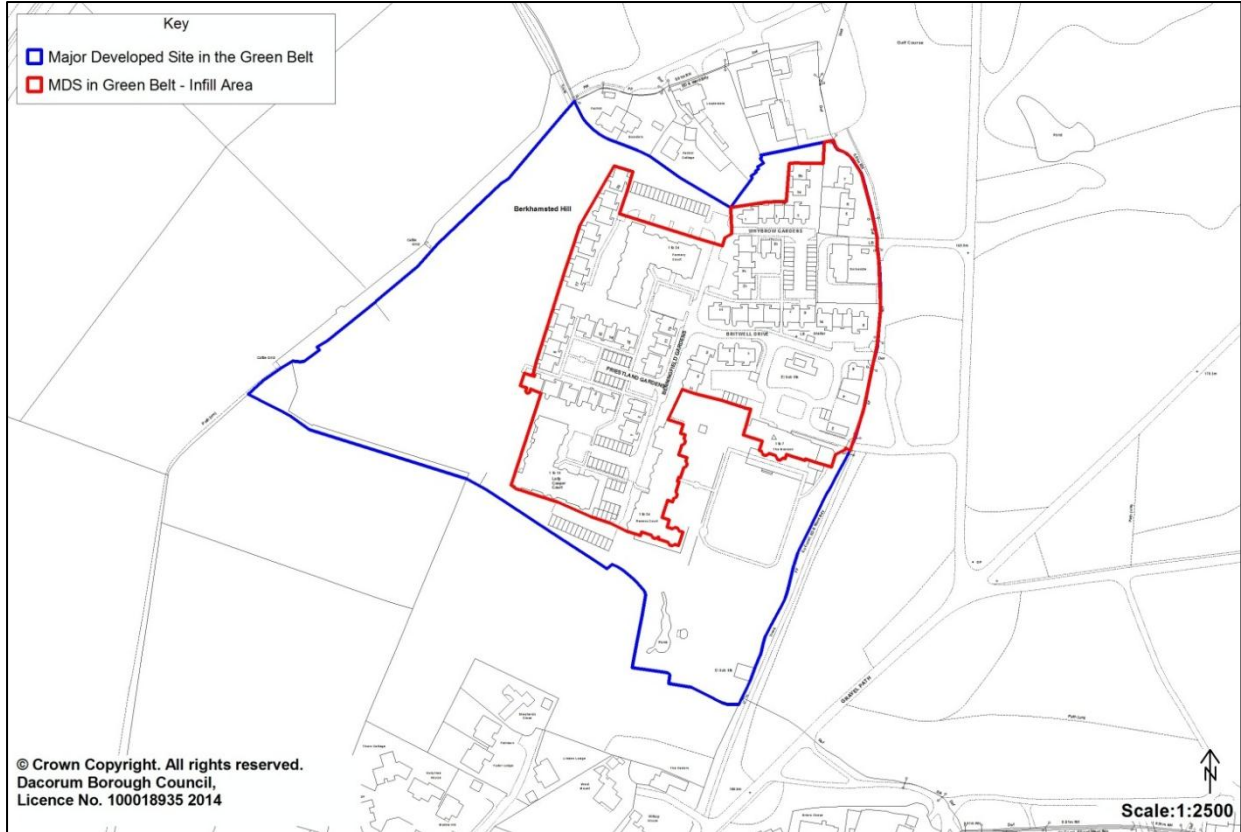

MDS/2 MDS/3 Ashlyns School – Extended Infill Area

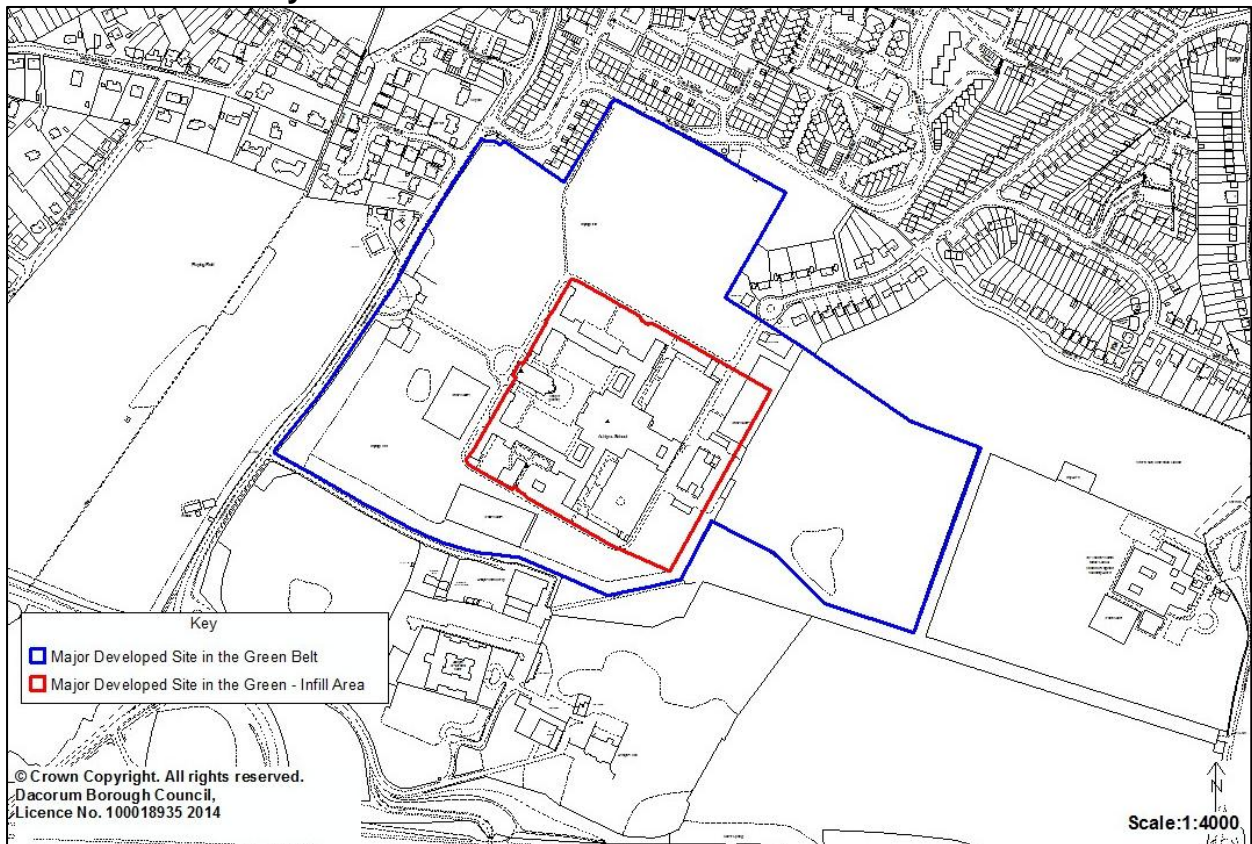

MDS/3 MDS/4 British Film Institute – Defined boundaries for New Major Developed Site in the Green Belt

British Film Institute

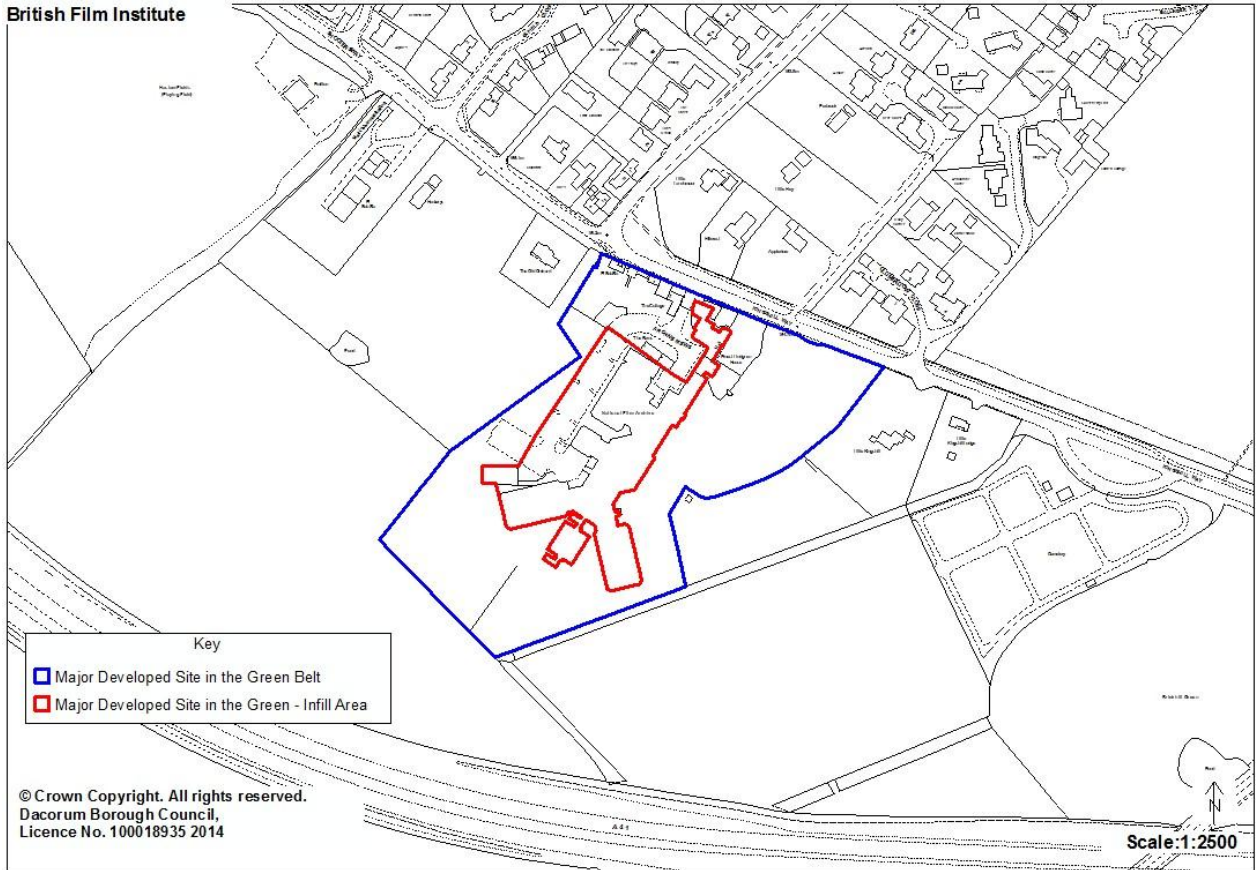

MDS/4 MDS/5 Bovingdon Brickworks – Extended external boundary

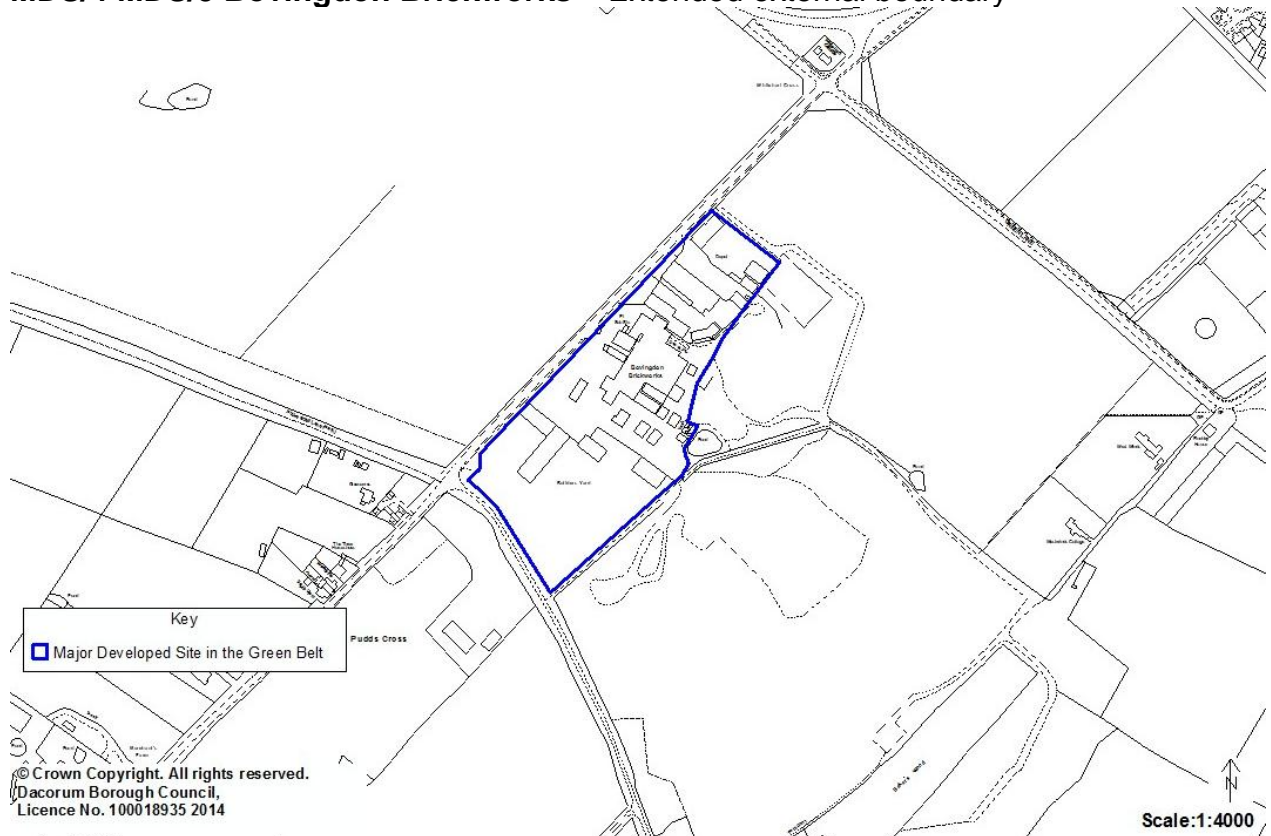

MDS/5 MDS/6 Bovingdon Prison – Extended Infill Area

Bovingdon Prison

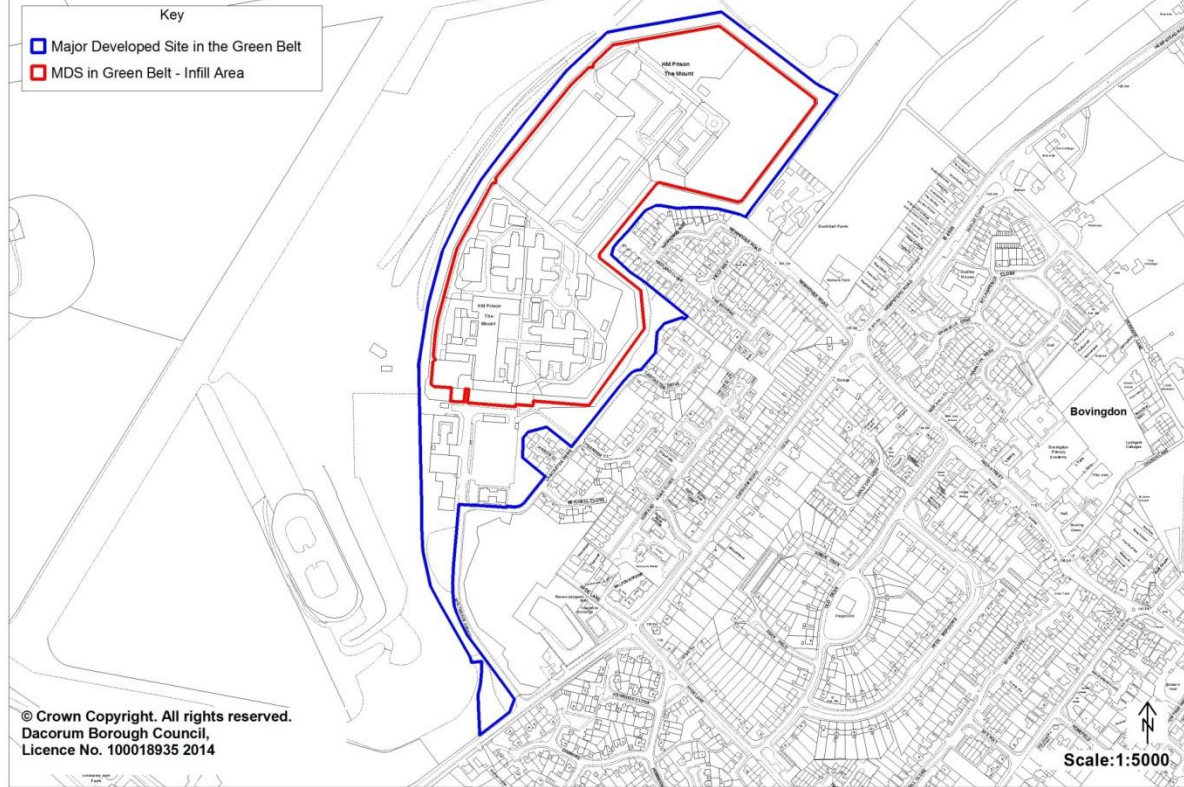

SC3 (below) (also see MC70)

~~MDS/6~~ **MDS/7 Kings Langley School** – Infill Area removed due to redevelopment of school buildings. New infill area defined.

Map in previous Pre-submission document:

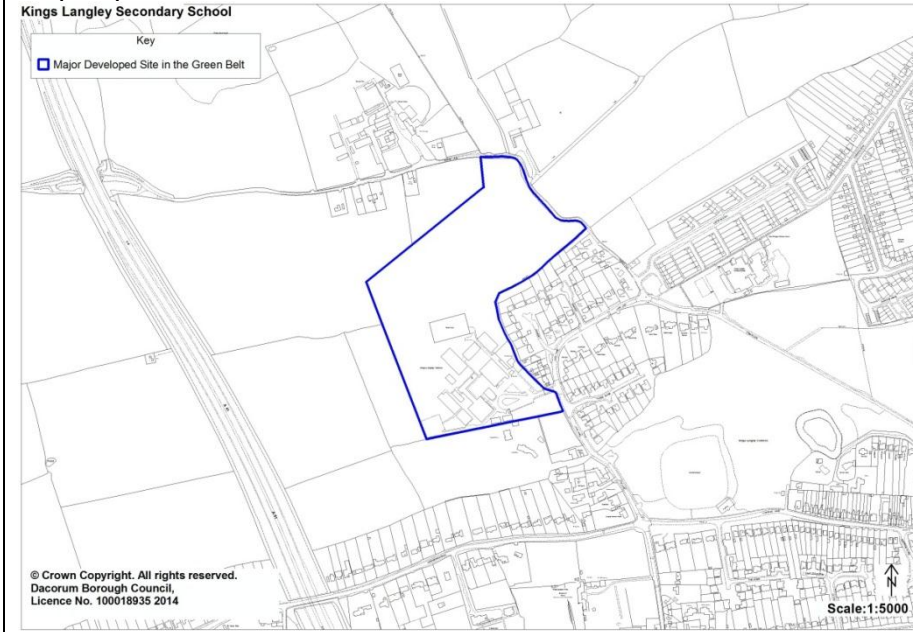

Amended map:

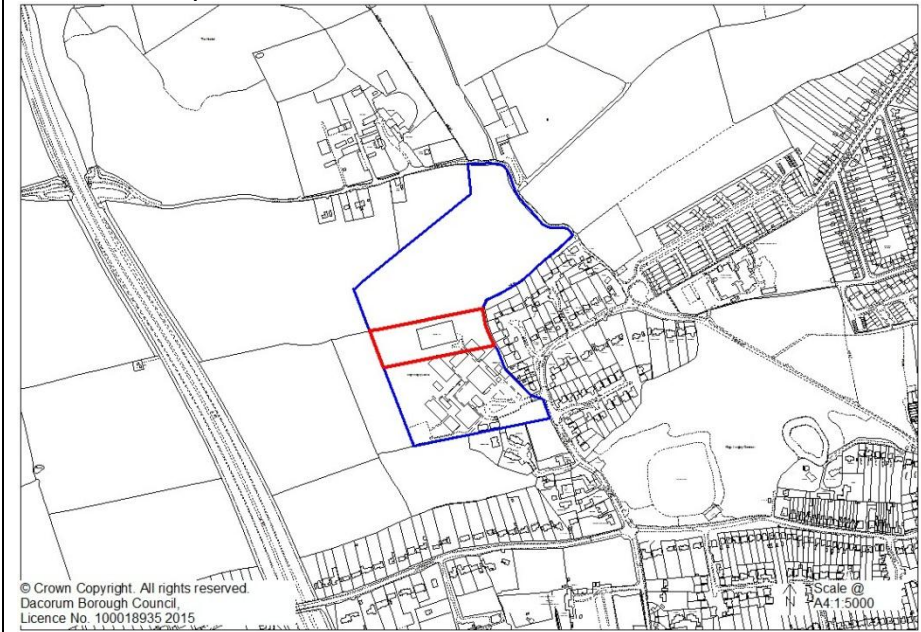

SC4 (below) (also see MC71)

~~MDS/7~~ MDS/8 Bourne End Mills Employment Area - External boundary amended

Map in previous Pre-submission document:

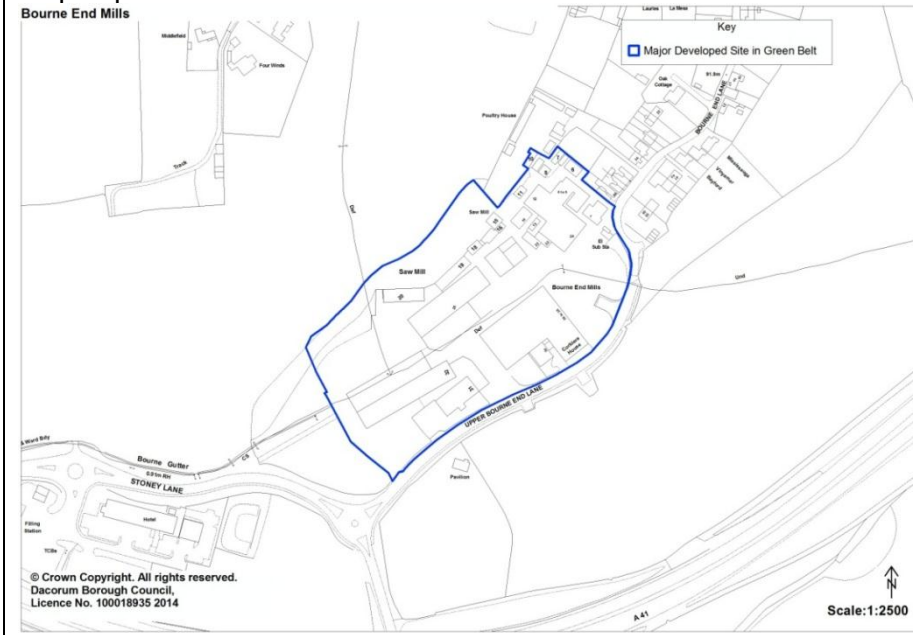

Amended map:

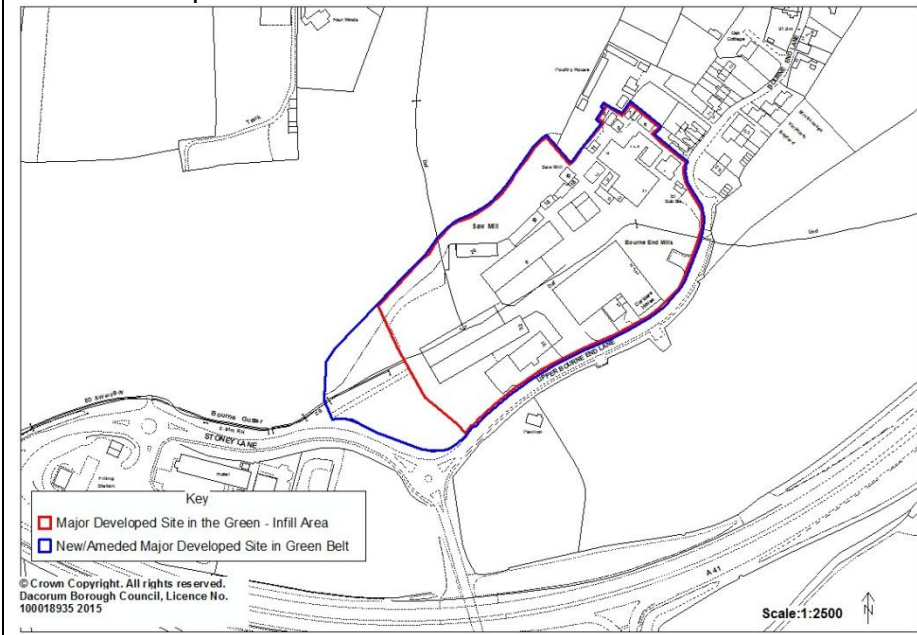

Mixed Use Proposals

MU/1 West Herts College site and Civic Zone, c/o Queensway/Marlowes/Combe Street (north)/ Leighton Buzzard Road, Hemel Hempstead – new proposal



MC5 (below)

MU/2 Hemel Hempstead Hospital Site, Hillfield Road, Hemel Hempstead – new proposal and remove existing social and community and leisure proposals

Map in previous Pre-submission document:



Amended map:



MU/3 Paradise/Wood Lane, Hemel Hempstead – new proposal and remove GEA designation

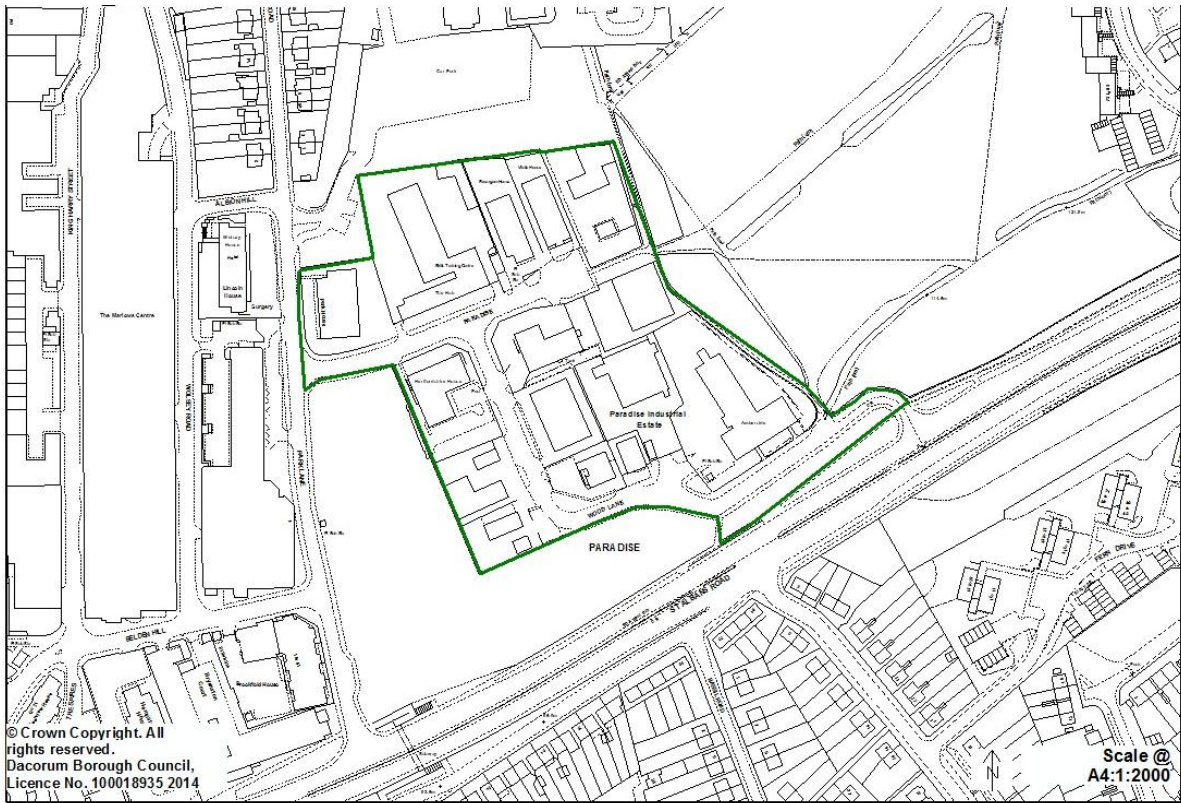

MU/4 Hemel Hempstead Station Gateway, London Road, Hemel Hempstead – new proposal



MU/5 Bunkers Park, Bedmond Road, Hemel Hempstead – new proposal and remove existing leisure proposal



MU/6 Land at Durrants Lane, Shootersway, Berkhamsted – new proposal and remove existing housing, social and community and leisure proposals



MU/7 Gossoms End/Billet Lane, Berkhamsted – new proposal and remove existing GEA designation

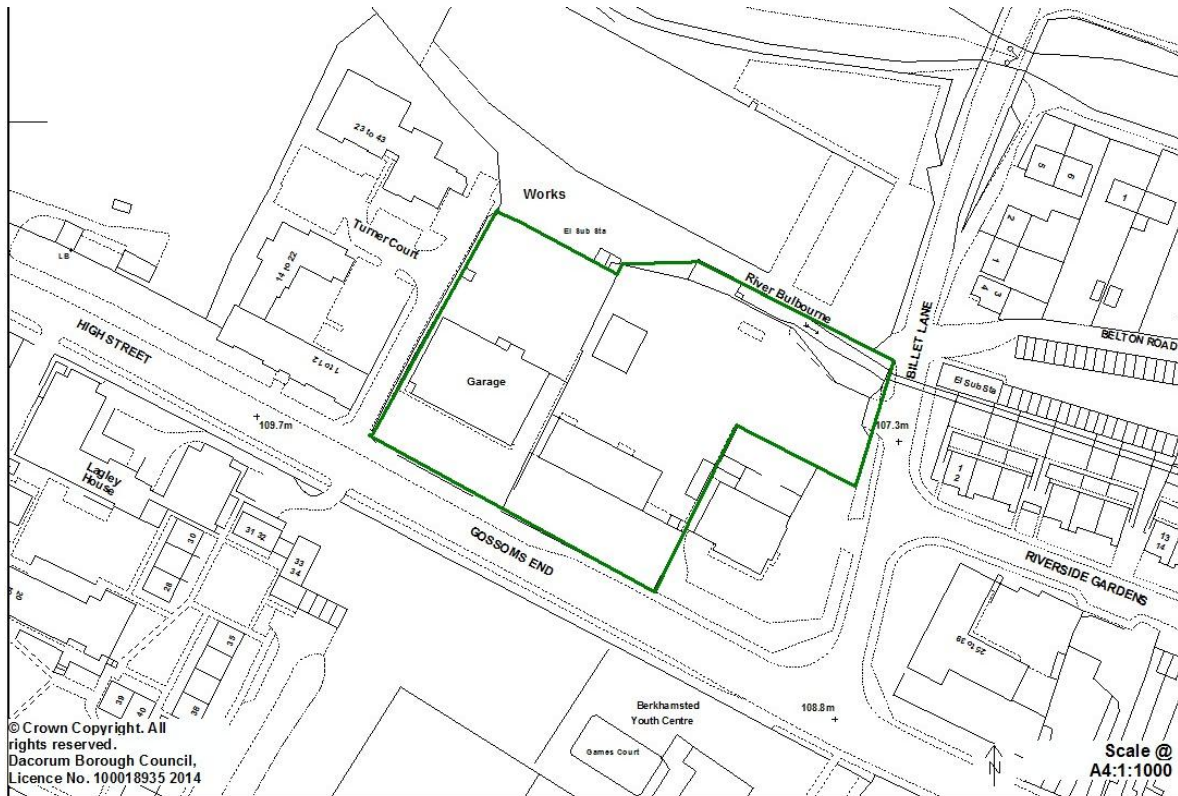

MC10 (below)

MU/8 Former Police Station, c/o High Street/Kings Road, Berkhamsted – new proposal



MC11 (below)

MU/9 Berkhamsted Civic Centre and land to r/o High Street, Berkhamsted – new proposal

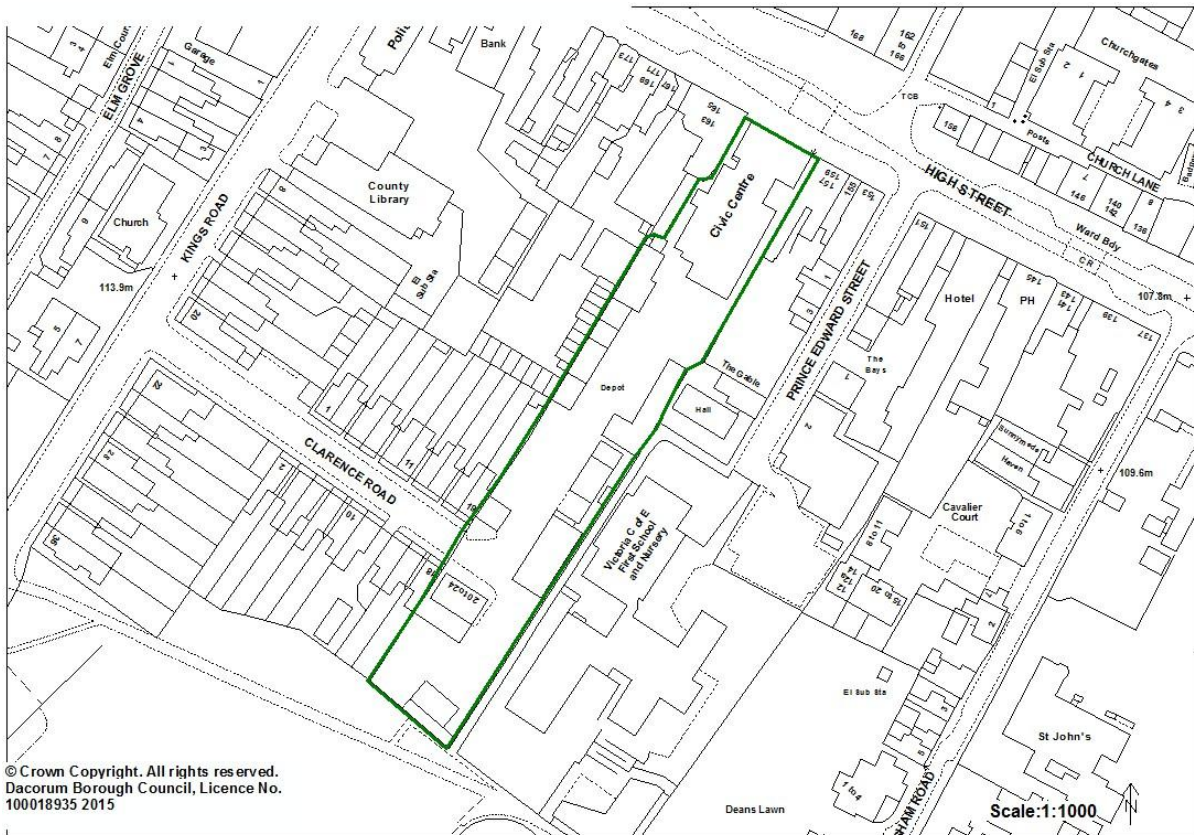

© Crown Copyright. All rights reserved.
Dacorum Borough Council, Licence No.
100018935 2015

